

Mod. 800 MI



Mod. 800 MI



U=1,1 W/m² * K tested by:  **ISTITUTO GIORDANO**
Qualità al Plurale.

Mod. 800 MI

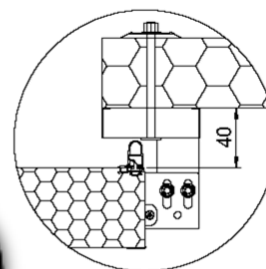
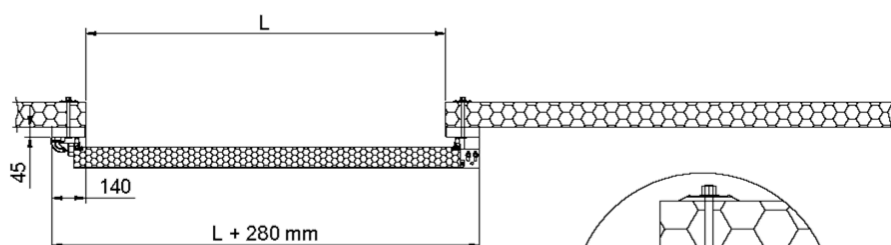
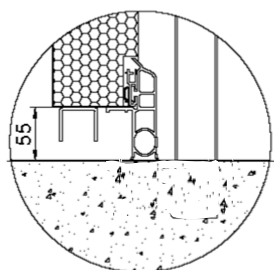
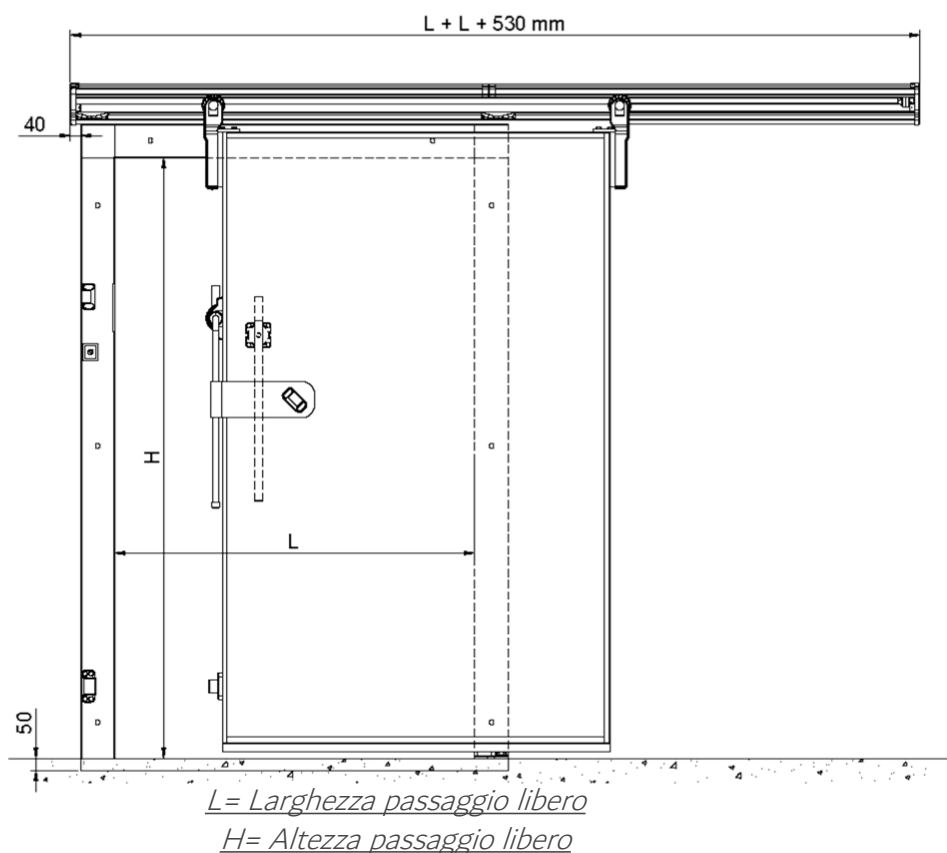
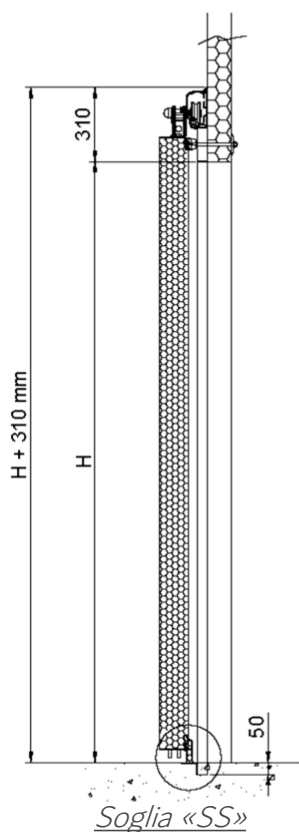

CARATTERISTICHE TECNICHE

- Spessore battente in alluminio 90 mm
- Rivestimento interno ed esterno in lamiera plastificata bianca Simil Ral 9003
- Guarnizione In EPDM a tenuta perimetrale ed inferiore
- Telaio piatto in Alluminio mm 140×45 fissaggio frontale
- Battente iniettato con poliuretano espanso "PUR" CFC free